



US 20190144074A1

(19) **United States**

(12) **Patent Application Publication**

Vigen

(10) **Pub. No.: US 2019/0144074 A1**

(43) **Pub. Date: May 16, 2019**

(54) **SNOW VEHICLE**

Publication Classification

(71) Applicant: **Arctic Cat Inc.**, Thief River Falls, MN (US)

(51) **Int. Cl.**
B62M 27/02 (2006.01)

(72) Inventor: **David L. Vigen**, Thief River Falls, MN (US)

(52) **U.S. Cl.**
CPC **B62M 27/02** (2013.01); **B62M 2027/027** (2013.01); **B62M 2027/025** (2013.01); **B62M 2027/023** (2013.01)

(21) Appl. No.: **16/192,000**

(57) **ABSTRACT**

(22) Filed: **Nov. 15, 2018**

Embodiments of the present disclosure describe a snow vehicle, comprising an engine mounted on a frame, a drive track, a drive train operatively interconnecting the engine with the drive track for delivering propulsive power to the drive track, and exhaust system. The exhaust system is positioned within an interior of the frame of the vehicle.

Related U.S. Application Data

(60) Provisional application No. 62/586,559, filed on Nov. 15, 2017.

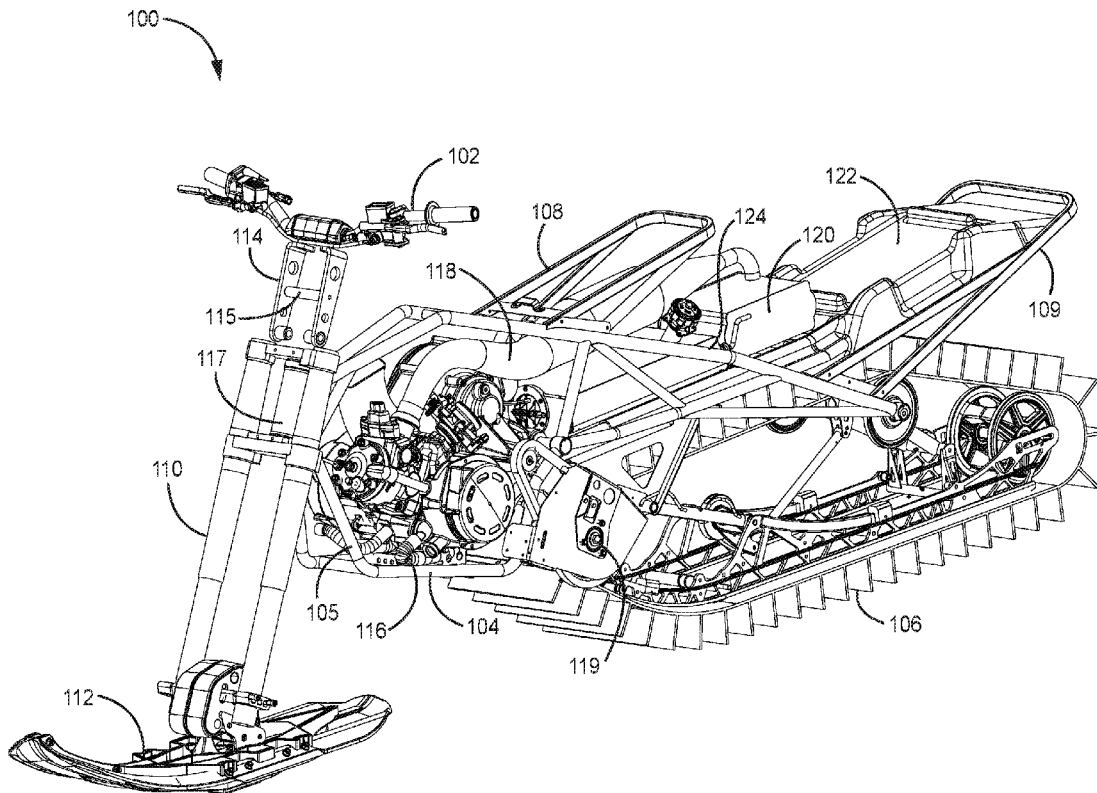

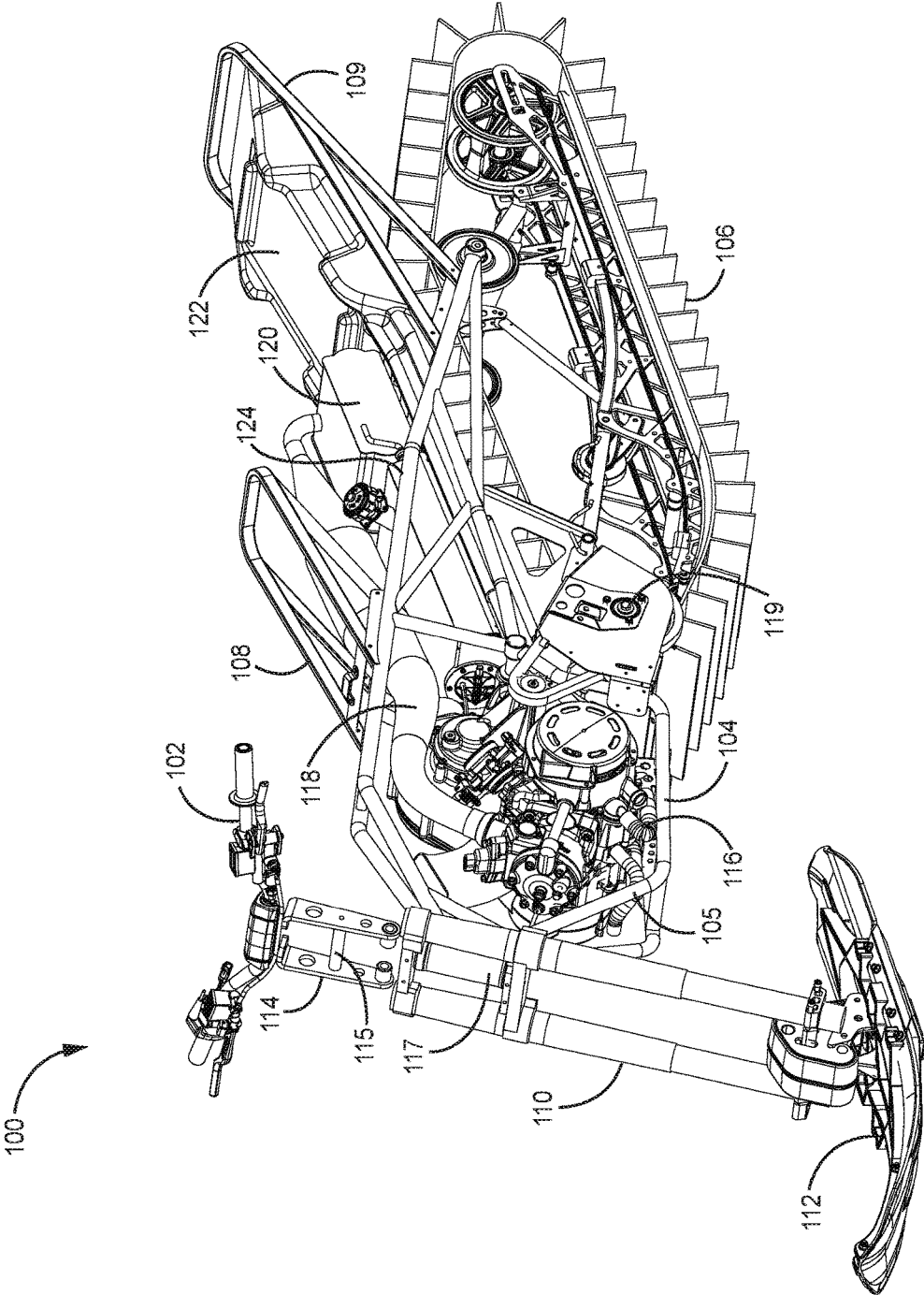

FIG. 1

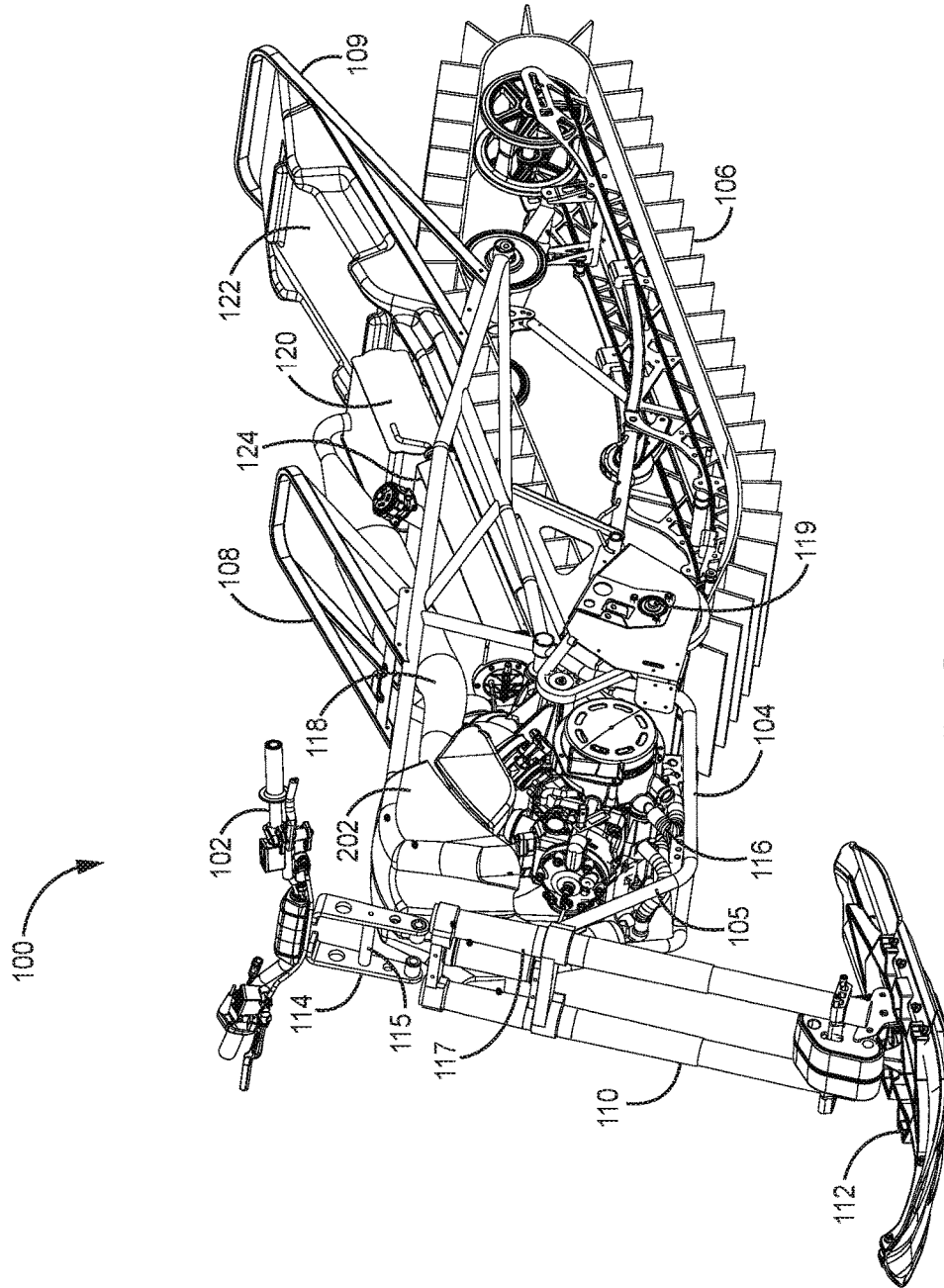

FIG. 2

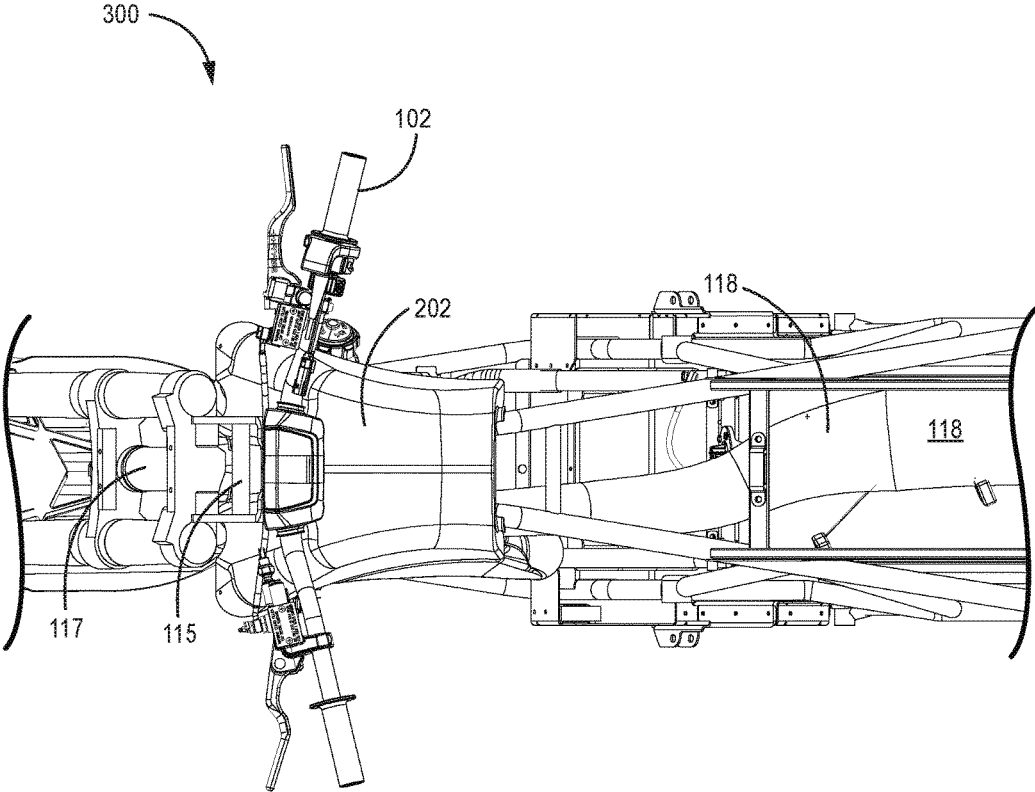

FIG. 3

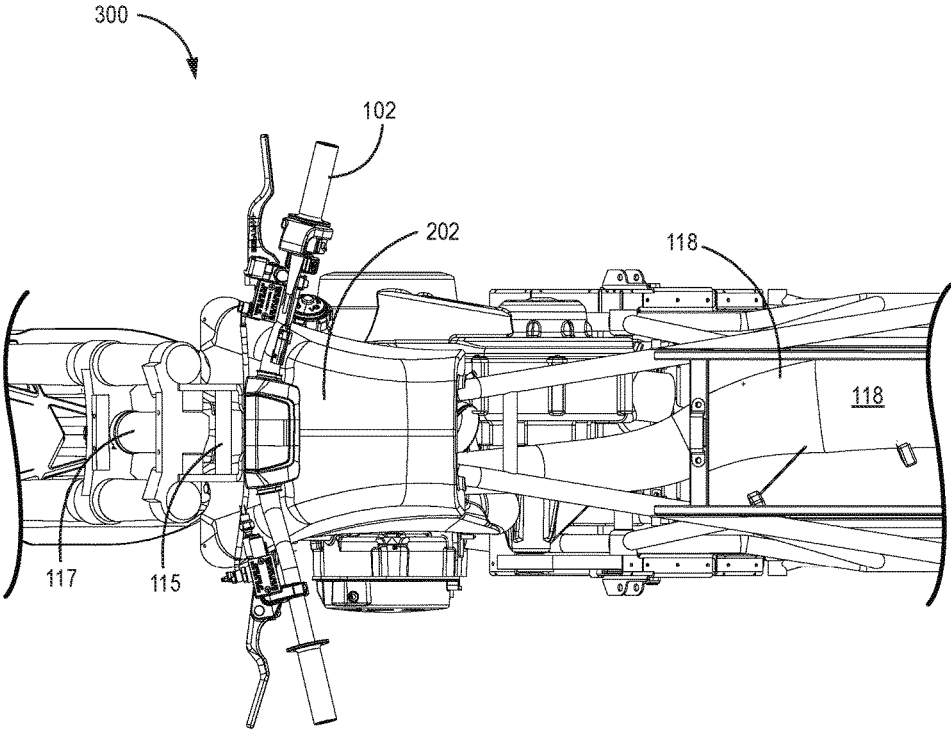

FIG. 4

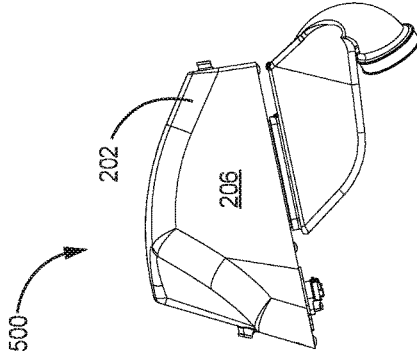

FIG. 5A

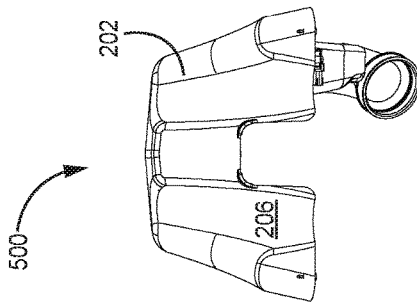

FIG. 5B

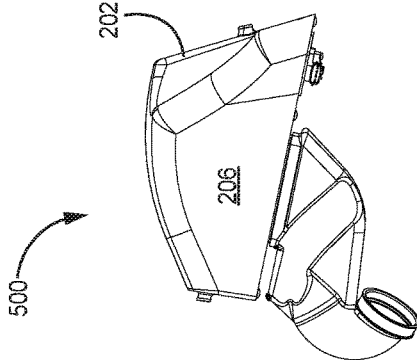

FIG. 5C

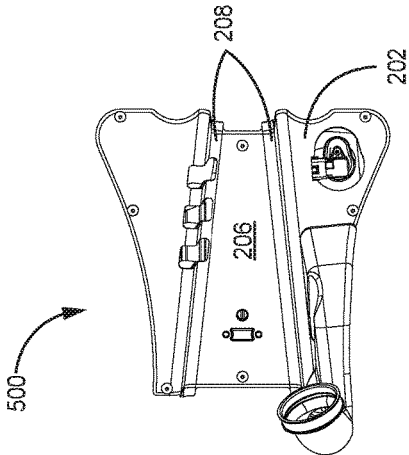

FIG. 5D

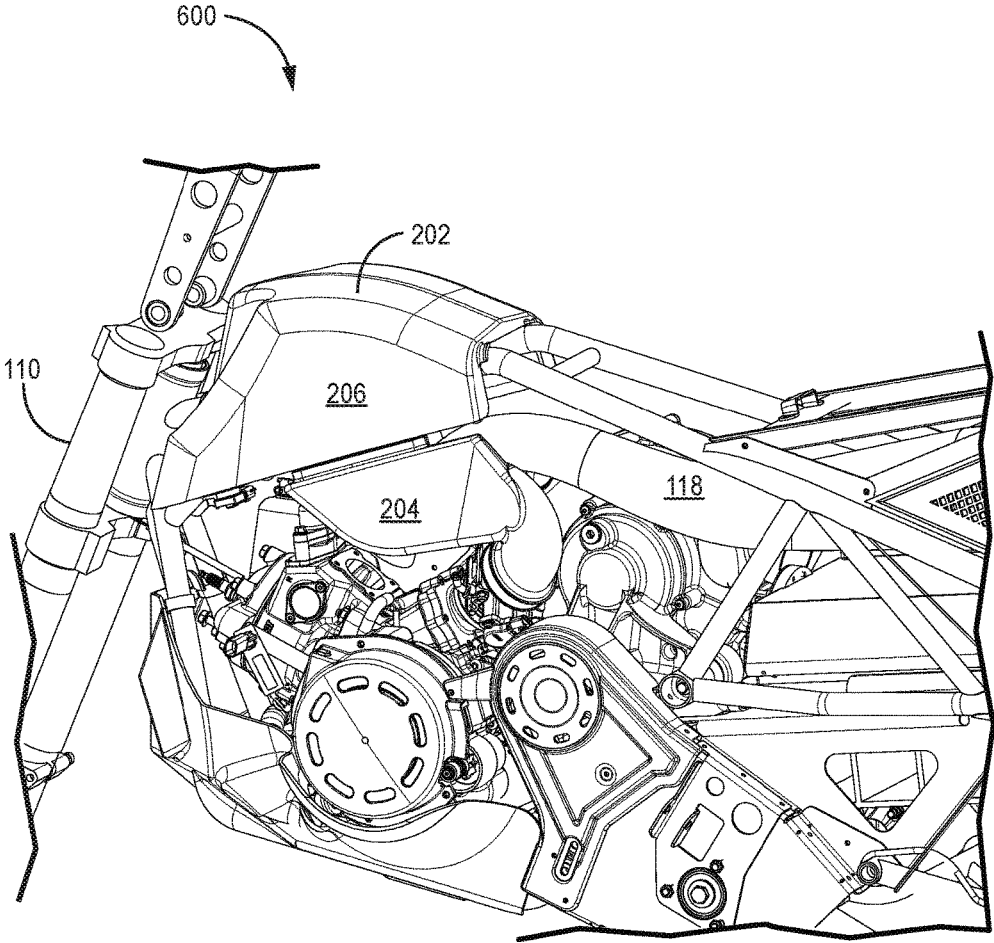

FIG. 6

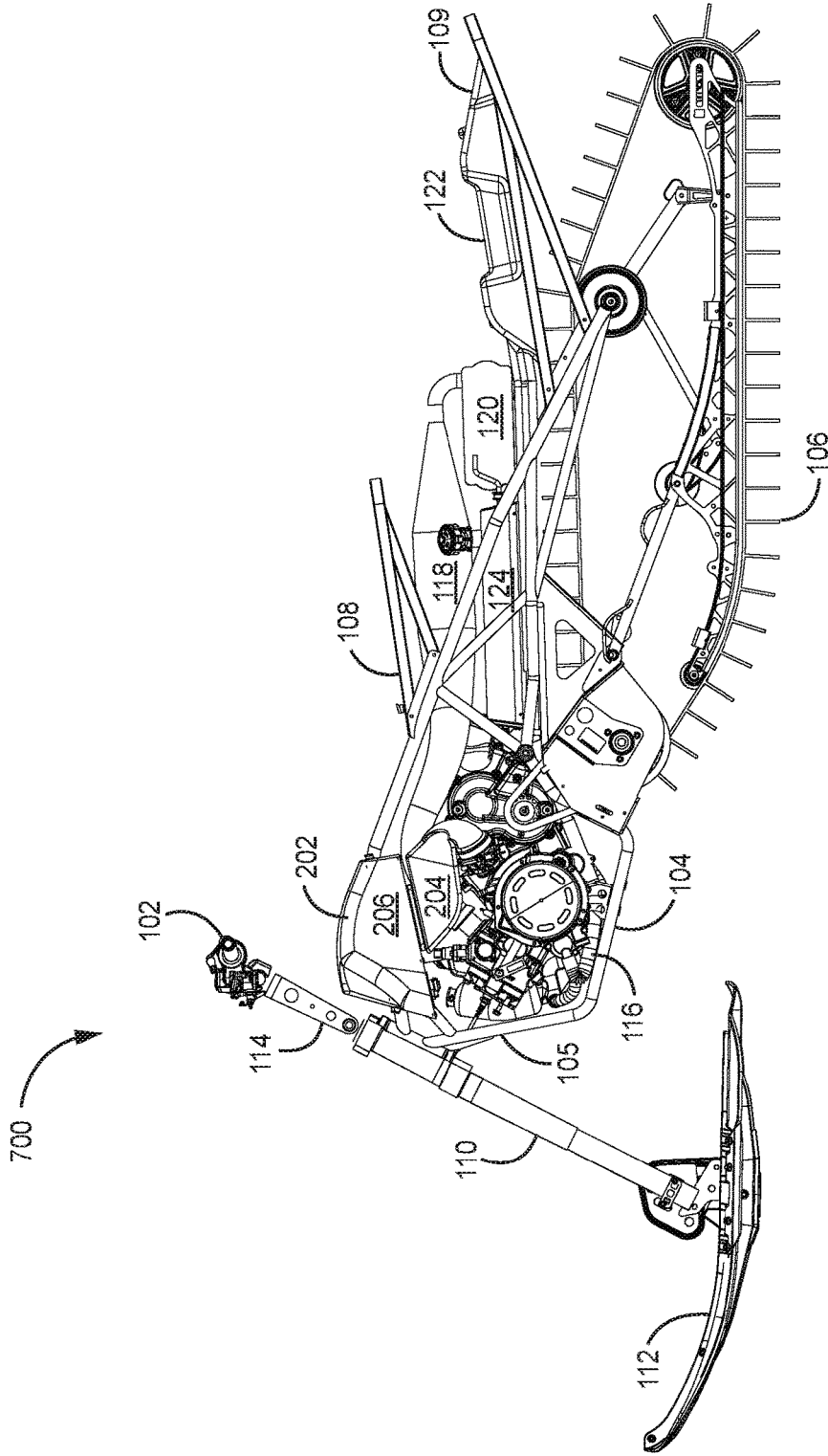

FIG. 7

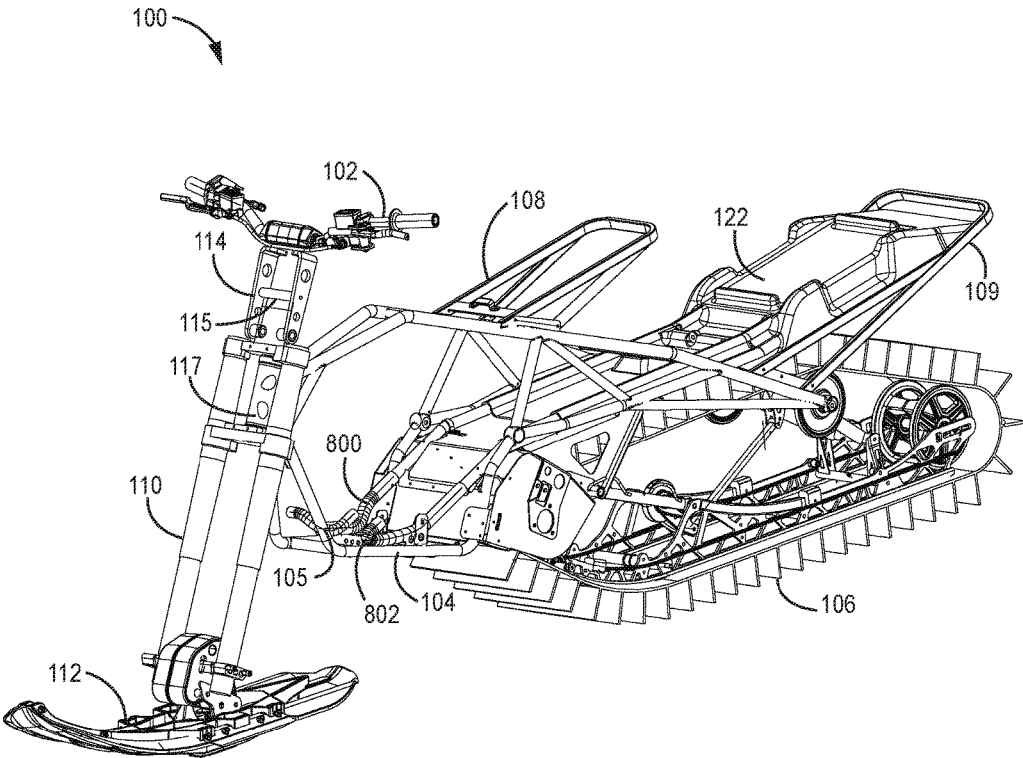

FIG. 8

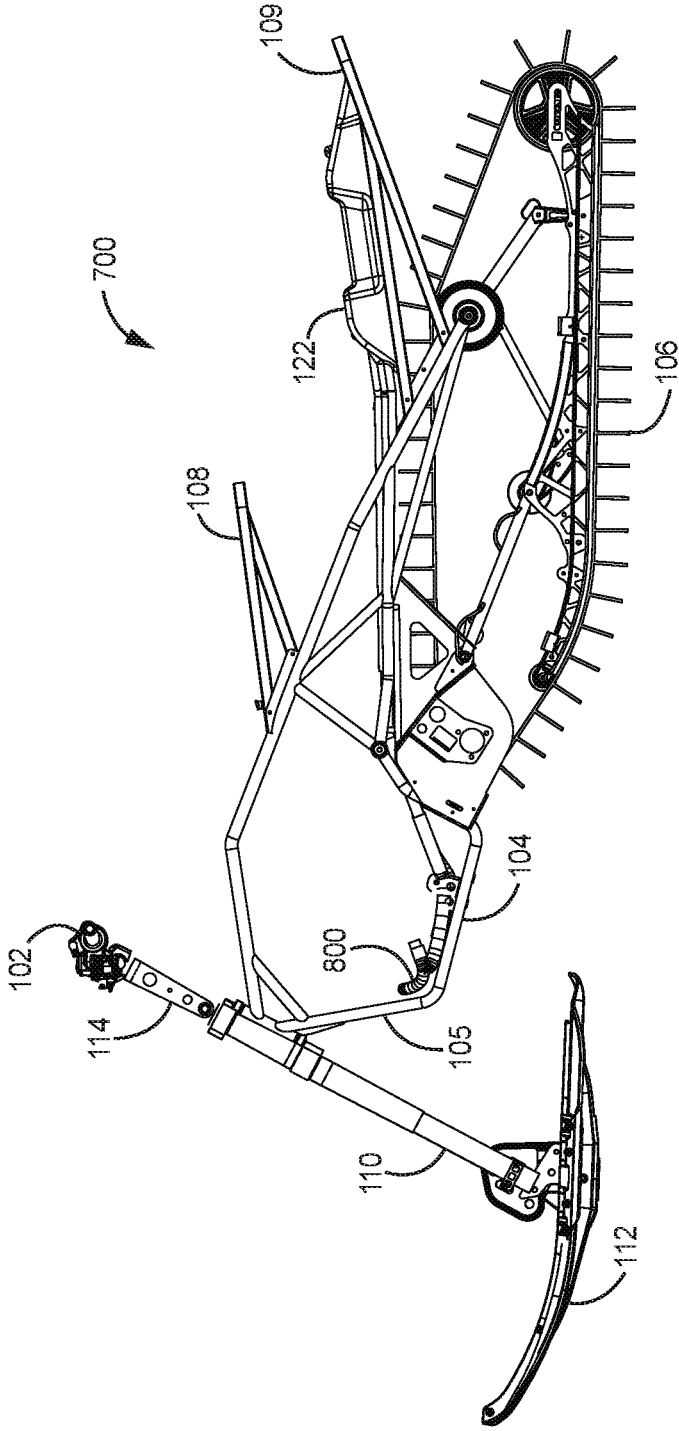

FIG. 9

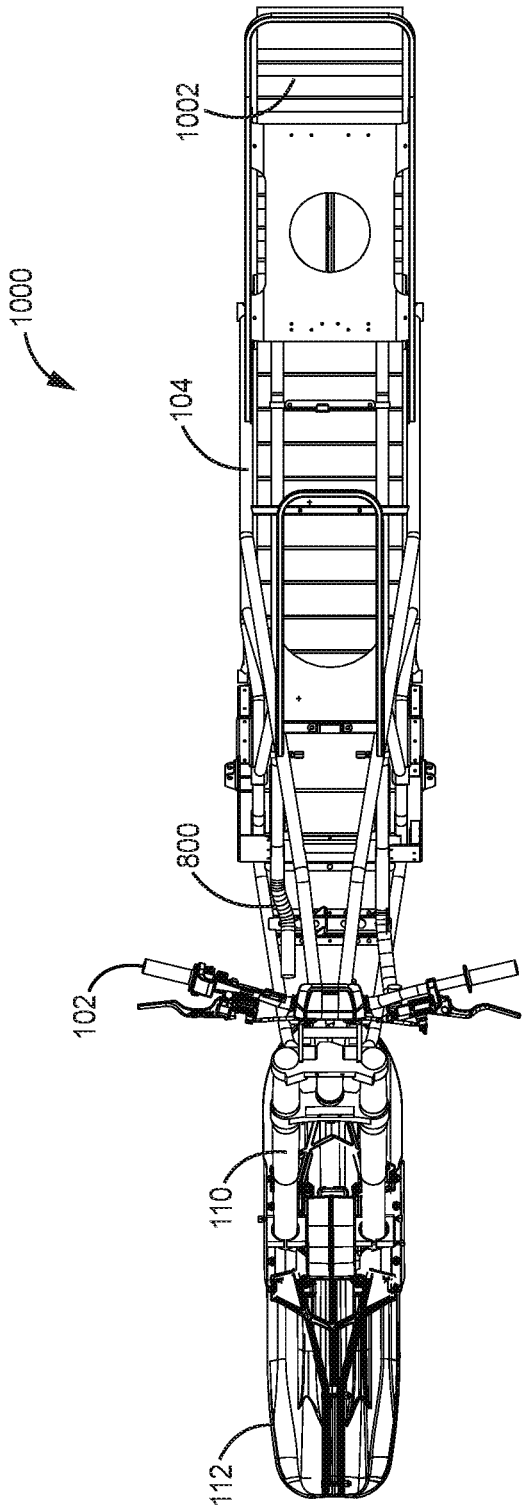

FIG. 10

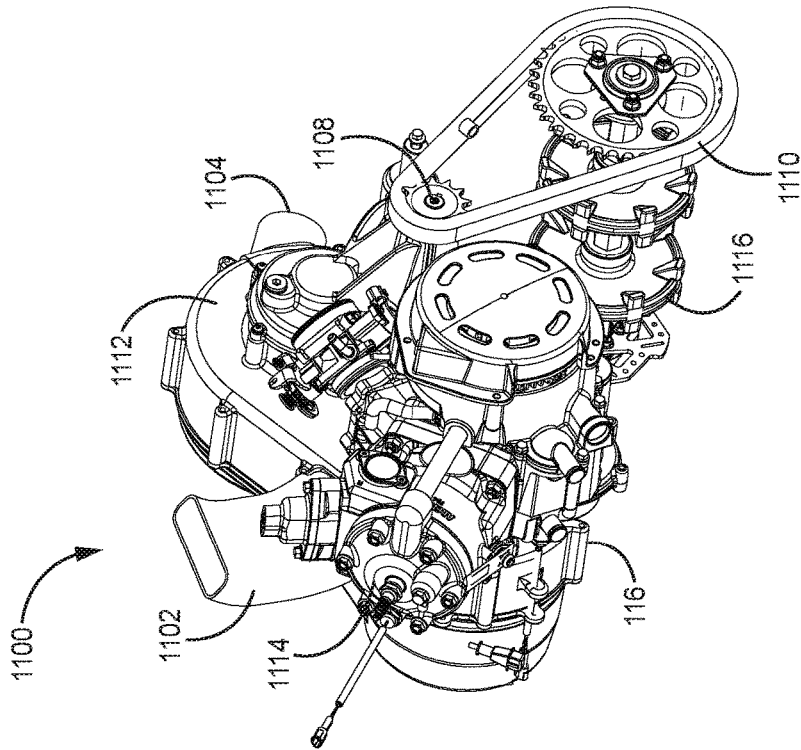

FIG. 11B

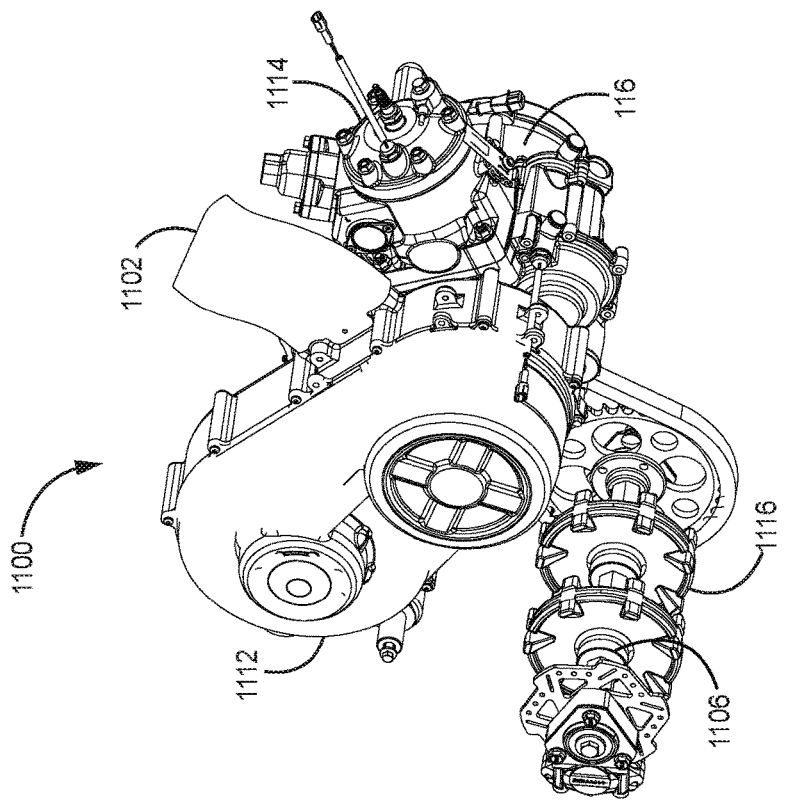
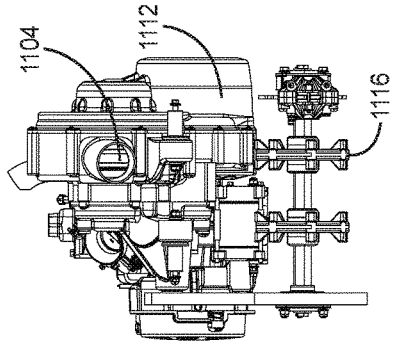
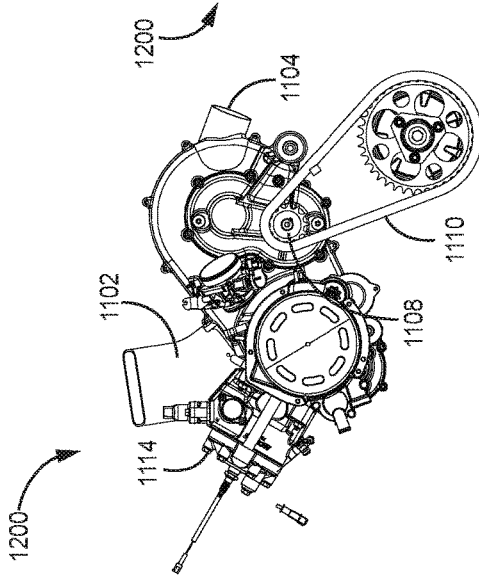
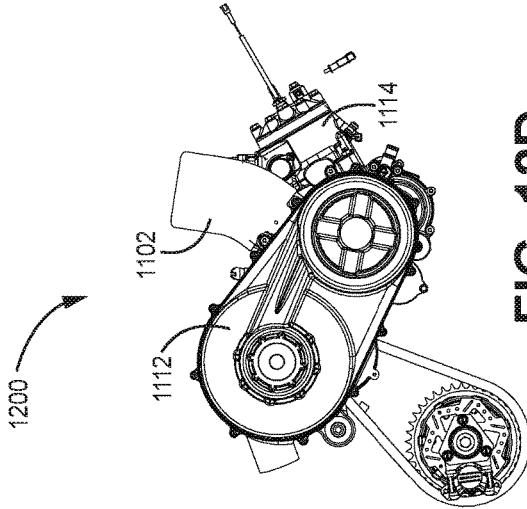
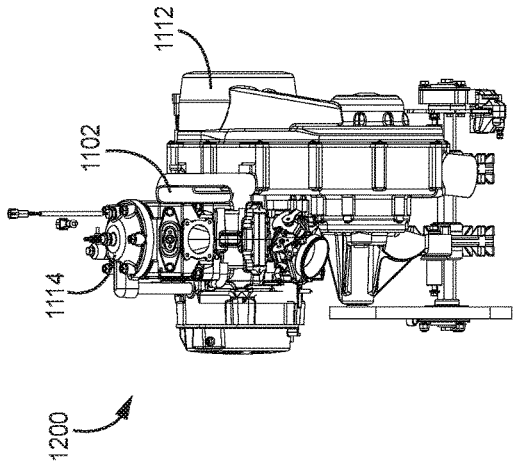

FIG. 11A



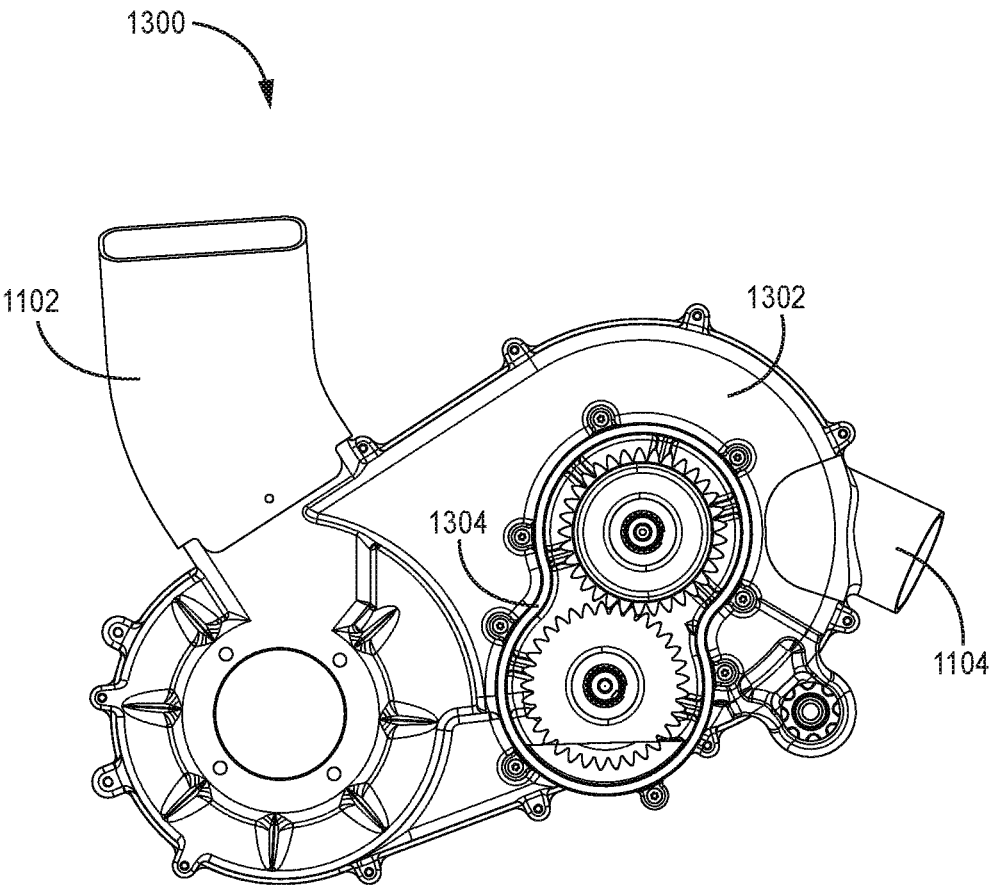

FIG. 13

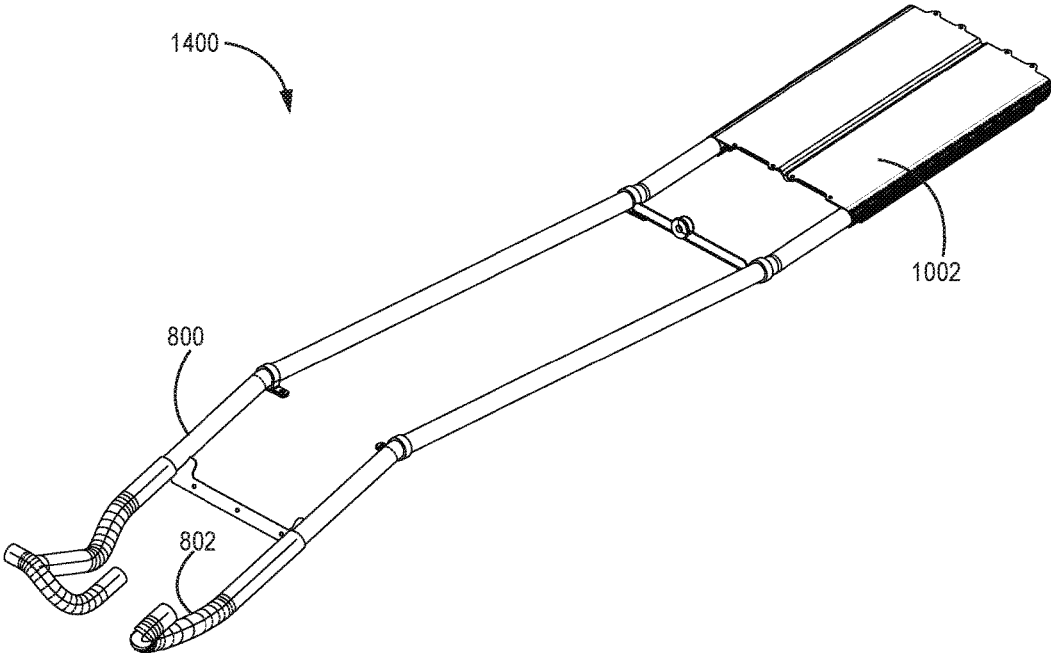

FIG. 14

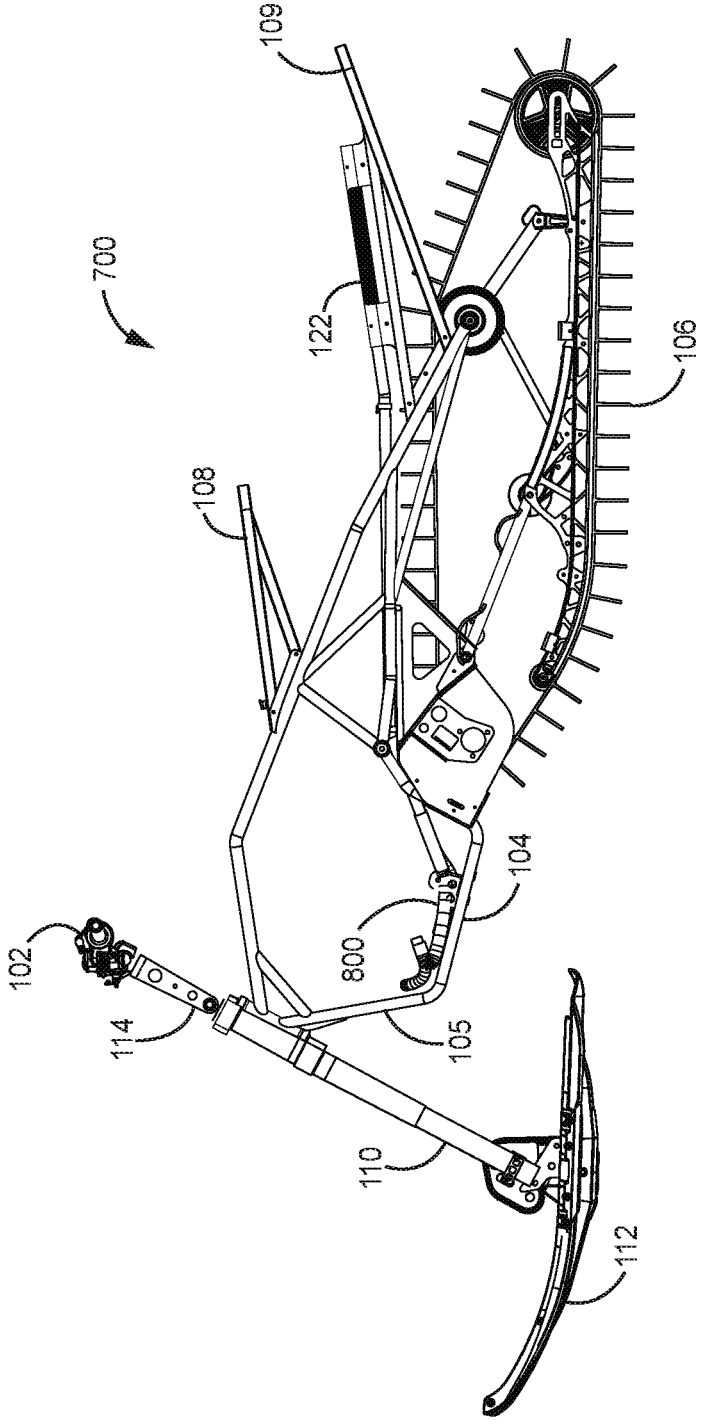

FIG. 15

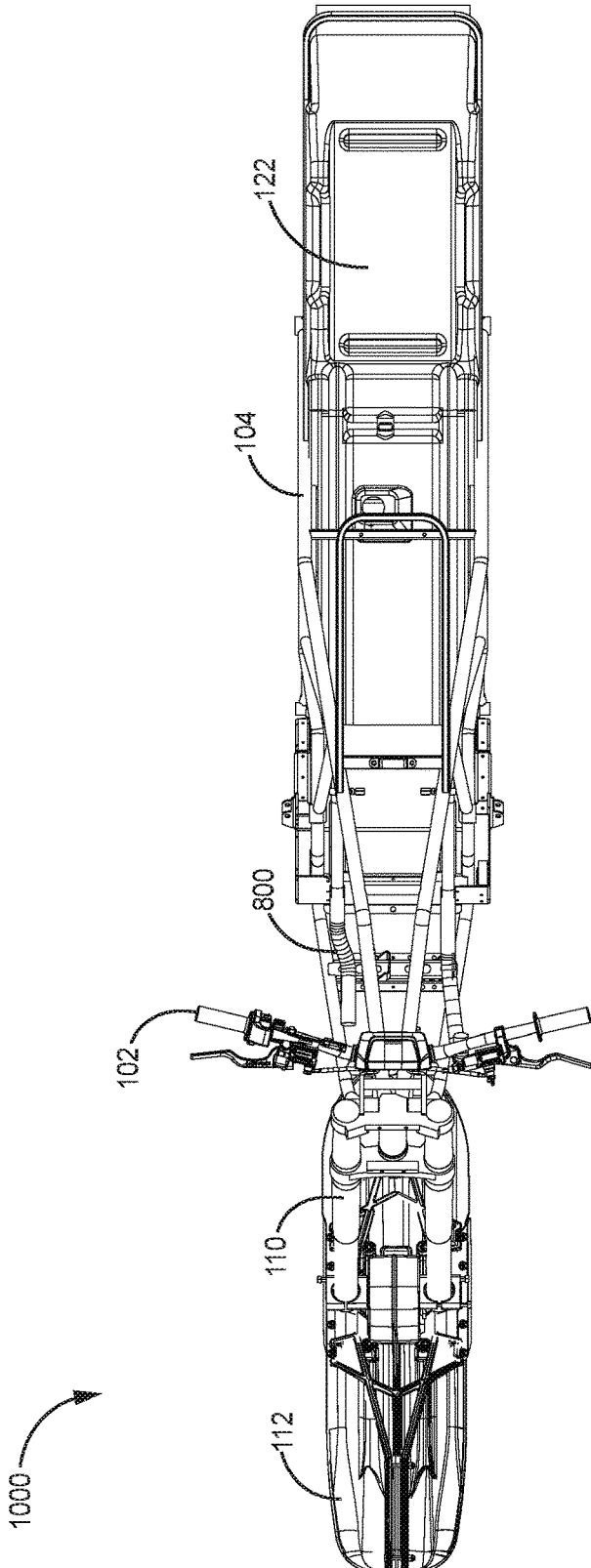

FIG. 16

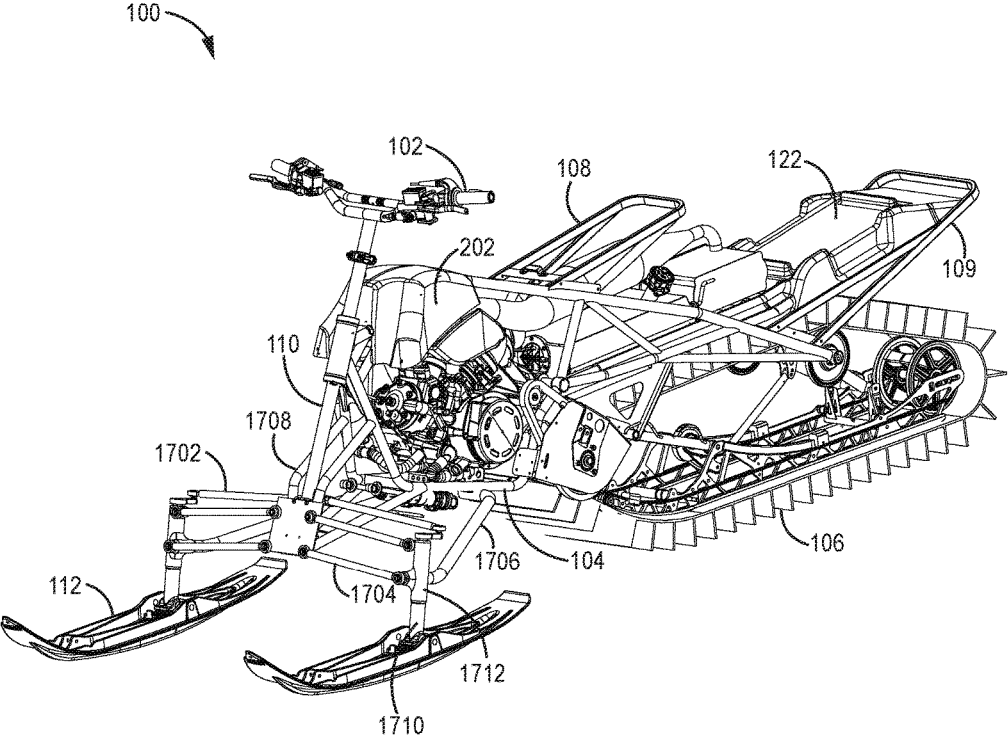

FIG. 17

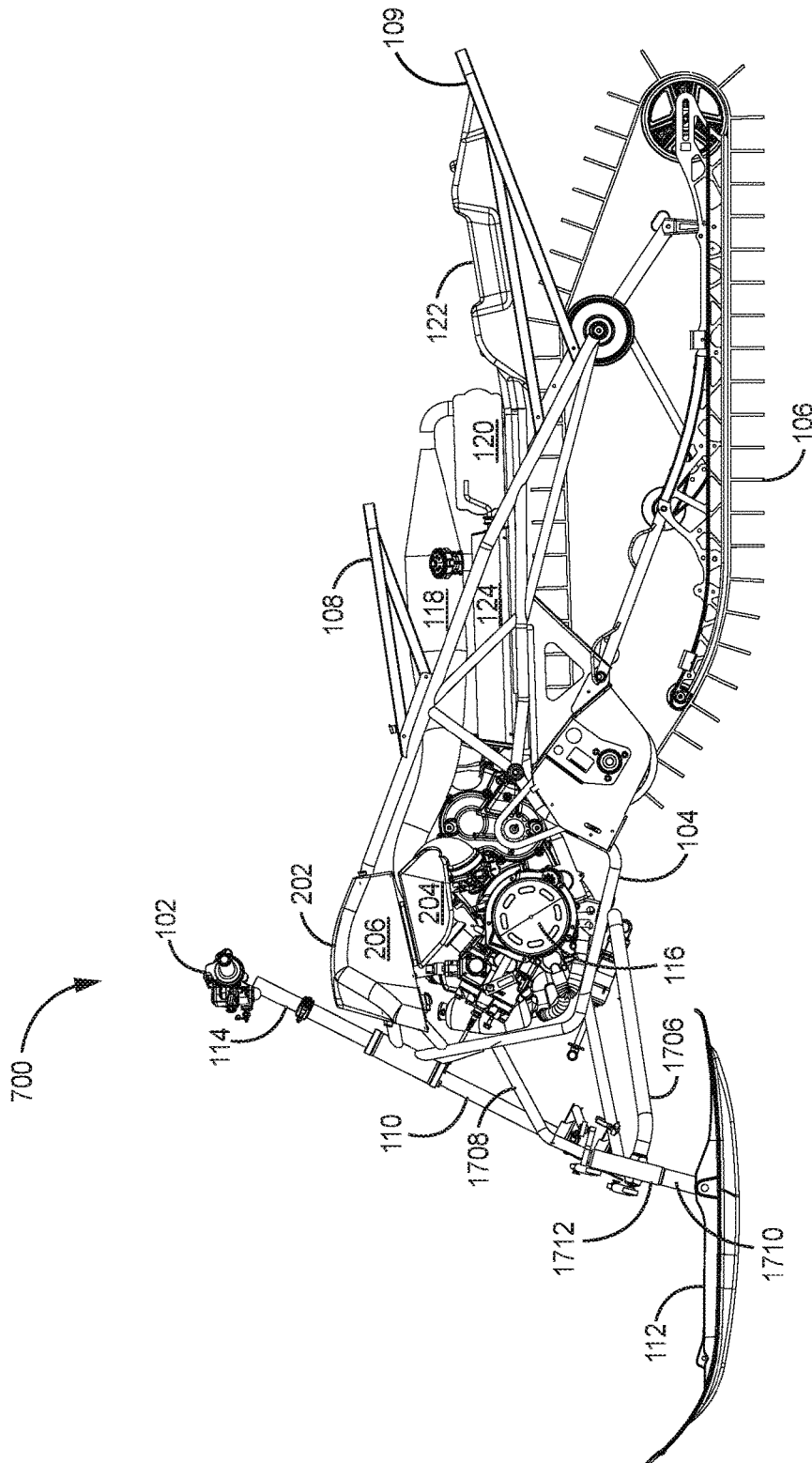

FIG. 18

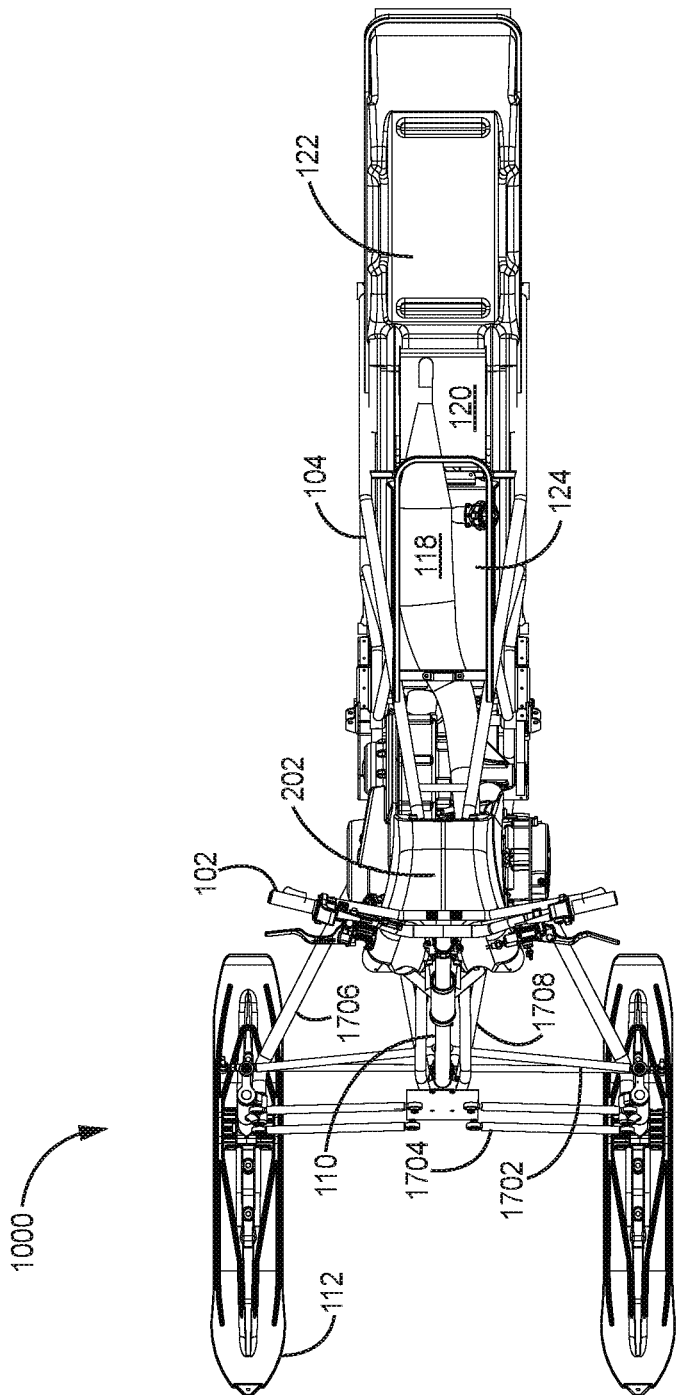

FIG. 19

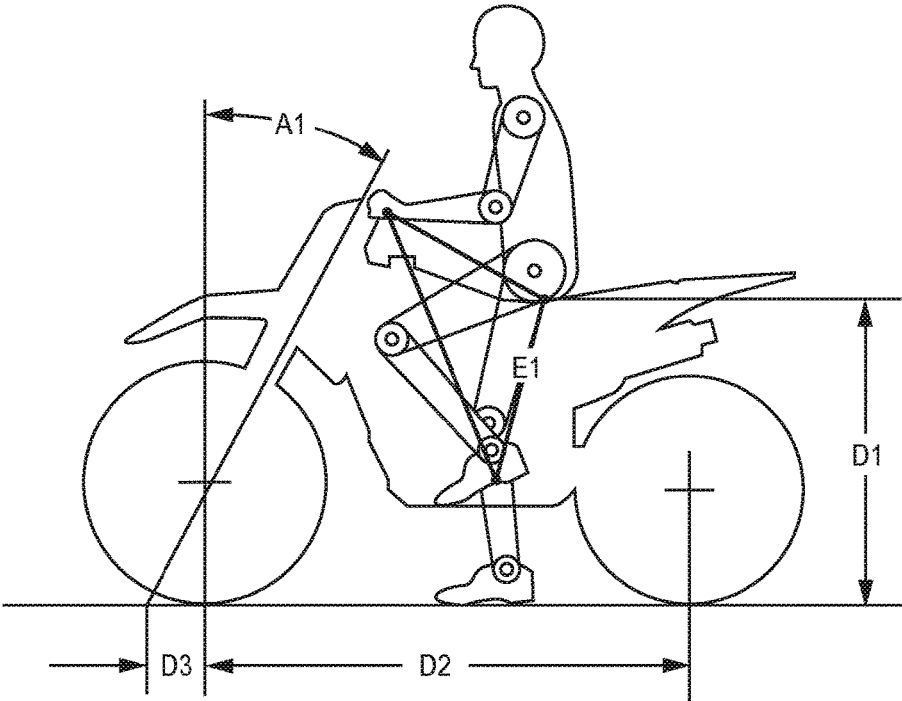

FIG. 20A

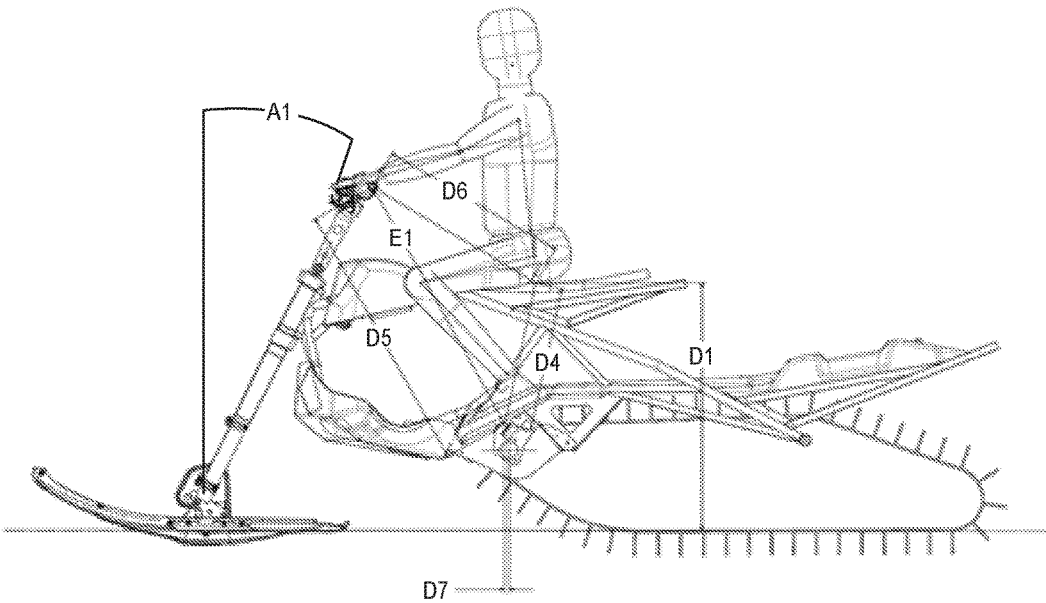

FIG. 20B

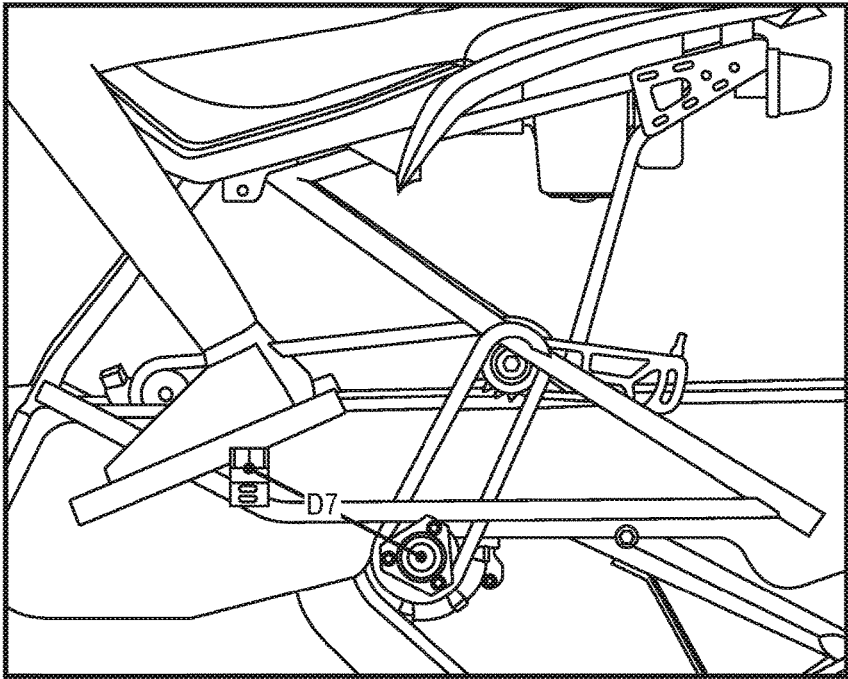

FIG. 20C

SNOW VEHICLE

CROSS-REFERENCE TO RELATED TO APPLICATION(S)

[0001] This application claims benefit of U.S. Provisional Application No. 62/586,559, filed on Nov. 14, 2017 and which application is incorporated herein by reference. A claim of priority is made.

BACKGROUND

[0002] In addition to traditional snowmobiles, an alternative snow vehicle is the snow bike or snow cycle. These vehicles are generally smaller and lighter than snowmobiles. Snow cycle designs are typically based upon off-road motorcycles with the front wheel replaced by a ski and the rear wheel replaced by an endless loop traction belt, commonly called a track. Snow bikes typically have a single steering ski and a relatively narrow track located behind and in line with the single ski.

SUMMARY

[0003] Embodiments of the present disclosure describe a snow vehicle, comprising an engine mounted on a frame, a drive track, a drive train operatively interconnecting the engine with the drive track for delivering propulsive power to the drive track, and exhaust system. The exhaust system is positioned within an interior of the frame of the vehicle.

[0004] Embodiments relate to a snow vehicle, comprising an engine mounted on a frame, a drive track, a drive train operatively interconnecting the engine with the drive track for delivering propulsive power to the drive track, and an engine air intake system, positioned above the engine. The air intake system includes a rearward positioned air intake port.

[0005] Embodiments also relate to a snow vehicle, comprising an engine mounted on a frame, a drive track, a drive train operatively interconnecting the engine with the drive track for delivering propulsive power to the drive track, an engine air intake system positioned above the engine, and an exhaust system positioned within an interior of the frame of the vehicle. The air intake system includes a rearwardly facing air intake port; and wherein the drive train includes a CVT.

BRIEF DESCRIPTION OF DRAWINGS

[0006] This written disclosure describes illustrative embodiments that are non-limiting and non-exhaustive. Reference is made to illustrative embodiments that are depicted in the figures, in which:

[0007] FIG. 1 illustrates a perspective view 100 of a snow vehicle, according to some embodiments.

[0008] FIG. 2 illustrates a perspective view 100 of a snow vehicle with air intake system, according to some embodiments.

[0009] FIG. 3 illustrates a partial top-down view 300 of a snow vehicle with air intake system (engine removed), according to some embodiments.

[0010] FIG. 4 illustrates a partial top-down view 300 of a snow vehicle with air intake system, according to some embodiments.

[0011] FIGS. 5A-D illustrate perspective views 500 of an air intake system, according to some embodiments.

[0012] FIG. 6 illustrates a partial side view 600 of a snow vehicle with air intake system, according to some embodiments.

[0013] FIG. 7 illustrates a side view 700 of a snow vehicle, according to some embodiments.

[0014] FIG. 8 illustrates a perspective view 100 of a snow vehicle with engine removed, according to some embodiments.

[0015] FIG. 9 illustrates a side view 700 of a snow vehicle with engine removed, according to some embodiments.

[0016] FIG. 10 illustrates a top-down view 1000 of a snow vehicle with cooling system, according to some embodiments.

[0017] FIGS. 11A-B illustrate perspective views 1100 of power train components, according to some embodiments.

[0018] FIGS. 12A-D illustrate perspective views 1200 of power train components, according to some embodiments.

[0019] FIG. 13 illustrates a side view 13 of a continuously variable transmission (CVT) housing with air handling components and drop box, according to some embodiments.

[0020] FIG. 14 illustrates a perspective view 1400 of a cooling system, according to some embodiments.

[0021] FIG. 15 illustrates a side view 700 of a snow vehicle with engine removed and with a cooling system, according to some embodiments.

[0022] FIG. 16 illustrates a top-down view 1000 of a snow vehicle tunnel shroud, according to some embodiments.

[0023] FIG. 17 illustrates a perspective view 100 of a snow vehicle with two-ski configuration, according to some embodiments.

[0024] FIG. 18 illustrates a side view 700 of a snow vehicle with two-ski configuration, according to some embodiments.

[0025] FIG. 19 illustrates a top-down view 1000 of a snow vehicle with two-ski configuration, according to some embodiments.

[0026] FIGS. 20A-C illustrate user or rider positioning in a dirt bike and in a snow vehicle, according to some embodiments.

DETAILED DESCRIPTION

[0027] Snow vehicles, such as snow bikes, are often created as modifications or kits of off-road motorcycles or dirt bikes. The front wheel is temporarily replaced by a ski and the rear wheel by a power track for gripping snow and ice. Such vehicles exceed noise and safety regulations and are therefore often restricted to use on closed courses. In snow vehicle applications, reducing the weight of individual components and overall vehicle weight, without sacrificing durability, function or utility, is an ongoing goal in product design. A lighter vehicle can increase performance and handling, among other characteristics. Embodiments of the present disclosure describe a purpose-built snow vehicle with numerous advantages over current snow vehicles and snow bike kits. Embodiments herein describe a snow vehicle utilizing a continuously variable transmission (CVT) with an air handling system. The snow vehicle includes an exhaust system positioned entirely within the chassis and tunnel of the vehicle, to prevent any contact with a user or their clothing. The snow vehicle further includes a lower center of gravity in the positioning of the vehicle components within the purpose-built frame. The engine is positioned lower and forward, and additional weight, such as one or more gas

tanks are further positioned to create the optimal center of gravity for handling and balance.

[0028] Embodiments herein describe a dropped fork component that creates a lower weight of the vehicle and additional adjustment of the handlebars. An engine air handling system provides a rear facing air intake for the engine. The purpose-built chassis or frame allows for greater space utilization and a lower center of gravity of the vehicle.

[0029] Referring to FIG. 1, a perspective view **100** of a snow vehicle is shown, according to some embodiments. A chassis or frame **104** supports an engine **116**, drive train components, a drive track **106**, handlebars **102** and one or more skis **112**. The chassis includes a seat frame **108**, lower front frame component **105**, and integrated bumper **109**. Exhaust system **118** connects to muffler **120**. The chassis **104** connects to a fork **110**, in contact with the one or more skis **112**. A drop fork component **114** connects the fork **110** and handlebars **102**. Fuel tank **124** is positioned beneath the exhaust system **118** and seat frame **108**. Tunnel shroud **122** is positioned in contact with the chassis **104** and above the drive track **106**. The track width can be about 10 inches to about 12 inches, about 12 inches to about 13 inches, about 12.5 inches, about 13.5 inches, or about 14 inches wide. A foot peg attachment **119** can be positioned near an exterior surface. Examples of drive track **106** and other embodiments can be found in co-owned U.S. Pat. No. 9,321,509, filed on Dec. 17, 2013 with first named inventor Andrew Beavis and entitled "Snowmobile Skid Frame Assembly", the contents of which are incorporated herein by reference.

[0030] In some embodiments, the exhaust system **118** is positioned completely within the tunnel and frame **104** of the vehicle. By rotating the position of the engine **116** one hundred eighty degrees from a typical snowmobile or motorcycle configuration, the exhaust port faces a rearward direction. The exhaust system **118** can then be contained in a substantially linear configuration towards the rear of the vehicle and into a muffler **120**. The muffler **120** can also be contained within an interior of the frame **104**. The exhaust then exits the rear of the vehicle. By positioning the exhaust system **118** completely within the frame **104** and tunnel of the vehicle, a user is protected from incidental contact on the hot surface of the exhaust system **118**. A partial top-down view of a snow vehicle is shown in FIG. 3, in which exhaust system **118** runs within the width of the frame **104**.

[0031] FIG. 2 additionally shows engine air intake system **202**, according to some embodiments. The air intake system **202** is positioned above the motor and can be attached to frame **104** or integrated with the frame **104**. Shown in FIGS. 3-4 in a partial top-down view **300**, the air handling system **202** encloses the frame **104** as the tube chassis runs through the box and supports its efficient placement and space utilization. The air handling system **202** can alternatively be positioned under the frame **104**.

[0032] Referring to FIGS. 5A-D, perspective views **500** of the air intake system **202** components are shown, according to some embodiments. The air box **206** collects and funnels air as the vehicle moves. The size and position of the air box allows for a sufficient volume of air to be collected and move through the system **202** to the engine. Once collected in box **206**, the air then travels through channel component **204** to the engine **116** (see view **600** of FIG. 6). Frame channels **208** can be positioned or formed on an interior or exterior surface for attachment or integration with the frame **104**.

[0033] Referring to FIG. 7, a side view **700** of a snow vehicle is shown, according to some embodiments. The frame **104** can be comprised of a tube chassis that maximizes the position of vehicle components for space utilization and weight reduction. As the snow vehicle is not a kit for motorcycles, the engine **116** can be positioned much lower and forward as any consideration for the position of a wheel is not needed. The lower front frame component **105** can be much closer to fork **110** than in traditional snow bike configurations. A traditional motorcycle user or rider posture is shown in FIG. 20A. The ergonomic position E1 is shown between foot peg, seat and handlebars. The angle A1 may be between about 27-30 degrees. D1 distance is about 29 inches in this example. D2 is about 48 inches and D3 about 3.2 inches. In one embodiment of the snow vehicle of the present disclosure (see FIG. 20B), a similar ergonomic position E1 is achieved. Hence, the rider or user is positioned in a similar manner with a user of a dirt bike. This differentiates from the position of a traditional snowmobile. In FIG. 20B, angle A1 can be about 24 to about 30 degrees, about 26 to about 28 degrees, or about 26.5 to about 27.5 degrees. D1 distance can be about 65 inches to about 100 inches. D1 can be about 75 inches to about 90 inches, or about 80 inches to about 90 inches for example. D6 can be about 20 inches to about 30 inches, about 22 inches to about 28 inches, or about 24 to about 26 inches. D4 can be about 15 inches to about 24 inches, about 17 inches to about 22 inches, or about 18 to about 20 inches. D5 can be about 28 inches to about 42 inches, about 32 inches to about 38 inches or about 34 inches to about 36 inches. D7 measures the distance between foot peg and track/drive shaft. Embodiments of the present invention allow for a smaller distance between the two components, as the engine **116** is positioned more forward. The track/drive shaft can even be positioned more forward than the foot peg. In motorcycles and snow kits of motorcycles, the track/drive shaft is typically about 6 to about 8 inches behind the foot peg (see D7 of FIG. 20C.). In FIG. 20B, the distance D7 can be about zero inches to about 1 inch positive (foot peg ahead of the drive shaft), or about zero inches to about 1 inch negative (drive shaft ahead of the foot peg), about 2 inches positive to about 2 inches negative, about 3 inches positive to about 3 inches negative, or about 4 inches positive to about 4 inches negative.

[0034] Additionally, the frame **104** includes integrated or attached bumper **109**. If attached, the bumper **109** can be bolted, welded, or otherwise fastened. If integrated, the bumper **109** can be of a continuous construction with the frame **104**. The bumper **109** can connect to the shroud **122** or be separated from shroud **122**. The bumper **109** can optionally support the shroud **122** at one or more connection points. As the bumper **109** is part of frame **104** or connected to frame **104**, the need for a structural tunnel shroud is removed as the bumper does not need to connect to the tunnel shroud. Current shroud **122** can be made of plastic or lightweight aluminum to further reduce weight of the vehicle. The placement of the engine **116** in a forward and lower configuration advantageously moves the center of gravity of the vehicle in a lower position. The position of the one or more fuel tanks **124** further supports the lower center of gravity.

[0035] Because the frame **104** is purpose-built to for this vehicle, the size and length of the fork **110** can be reduced. The frame **104** can connect with fork **110** at a lower position. The connection between frame **104** and fork **110** can be

gusset bracket **117**. The gusset bracket **117** can transfer and distribute load throughout the frame **104**. A drop fork component **114** can then be utilized to connect the fork **110** and handlebars **102**. The drop fork component **114** is lighter than any corresponding length of fork **110** and can further be utilized for fore and aft handlebar adjustment and rotational adjustment for the user. The drop fork component **114** can include support components **115**, such as a cross brace. The drop fork component **114** can be manufactured of light weight, but durable materials, such as aluminum for example. The length of the drop fork component **114** can be about 8 inches, about 10 inches, or about 12 inches. The length of the drop fork component **114** can be about 6 inches to about 12 inches. The fork **110** can also include suspension components, such as dampeners, springs, coils, etc. The front suspension can be telescoping compression dampening component or rebound dampening component, for example.

[0036] Referring to FIG. 8, a perspective view **100** of a snow vehicle with engine **116** removed and with cooling system **800** is shown, according to some embodiments. With the engine **116** removed from view, the cooling system **800** can be seen. The cooling lines **802** connect to the engine **116**, and a pump (not shown) moves coolant to heat exchanger **1002** (see view **1400** of FIG. 14). The tunnel shroud **122** (see top view **1000** of FIG. 16) covers the heat exchanger **1002** (see view **700** of FIG. 15 and top view **1000** of FIG. 10) and deflects snow onto the exchanger **1002** to assist in cooling the liquid coolant (see view **700** of FIG. 9). As discussed above, the tunnel shroud **122** can be manufactured of light weight materials, such as plastic or aluminum as the need for structural support has been removed by integrating such function into frame **104**. The shroud **122** can be vacuum formed, molded, or shaped into various shapes or configurations for snow deflection functionality and aesthetic considerations.

[0037] Referring to FIGS. 11A-B, 12A-D perspective views **1100**, **1200** of power train components are shown, according to some embodiments. The drive train of the snow vehicle includes a continuously variable transmission (CVT), for transferring power from the engine **116** to the drive track **106**. The use of an automatic transmission makes for a smoother user experience and handling as compared to manual transmission. An engine **116** converts chemical energy to mechanical energy via a rotating input shaft in contact with a transmission or drive train, such as a CVT. The CVT housing **1112** includes a rotatable drive (or primary) clutch connected to the input shaft. The CVT also includes a rotatable driven (or secondary) clutch connected to an output shaft or jack shaft **1108**, the driven clutch having a laterally stationary sheave and a laterally movable sheave that is normally biased toward the stationary sheave. An endless flexible drive belt is disposed about the drive and driven clutches. Typically, the CVT transmission is connected to the output shaft **1108** of the vehicle's engine, the transmission providing continuously variable gear reduction from the relatively higher rotation speed of the engine to the relatively lower rotation speed of the vehicle drive axle. The CVT **1112** is used in conjunction with or integrated with a gear or drop box **1302** (see view **1300** of FIG. 13), for correcting the rotation of the output shaft **1108** due to the position of the engine. The drop box **1302** can include two or more gears **1304**. The CVT housing **1112** with drop box **1302** is connected to the jack shaft **1108**. Power is transferred via a belt **1110** from the jack shaft **1108** to driveshaft **1106**, connected by suitable linkages (sprockets **1116**, for example) to the drive track **106**.

[0038] The endless, flexible, generally V-shaped drive belt is disposed about the clutches within housing **1112**. Each of

the clutches has a pair of complementary sheaves, one of the sheaves being laterally movable with respect to the other. The effective gear ratio of the transmission is determined by the positions of the movable sheaves in each of the clutches. The secondary driven clutch has its sheaves normally biased together (e.g., by a torsion spring working in combination with a helix-type cam, as described below), so that when the engine is at idle speeds the drive belt rides near the outer perimeter of the driven clutch sheaves.

[0039] The spacing of the sheaves in the primary drive clutch usually is controlled by centrifugal flyweights. As the drive clutch rotates faster (in response to increased engine rpm) the flyweights urge the movable sheave toward the stationary sheave. This pinches the drive belt, causing the belt to begin rotating with the drive clutch, the belt in turn causing the driven clutch to begin to rotate. Further movement of the drive clutch's movable sheave toward the stationary sheave forces the belt to climb outwardly on the drive clutch sheaves, increasing the effective diameter of the drive belt path around the drive clutch. Thus, the spacing of the sheaves in the drive clutch changes based on engine rpm. The clutch therefore can be said to be speed sensitive.

[0040] As the sheaves of the drive clutch pinch the drive belt and force the belt to climb outwardly on the drive clutch sheaves, the belt (not being stretchable) is pulled inwardly between the sheaves of the driven clutch, decreasing the effective diameter of the drive belt path around the driven clutch. This movement of the belt inwardly and outwardly on the drive and driven clutches smoothly changes the effective gear ratio of the transmission in infinitely variable increments.

[0041] The CVT housing **1112** includes air handling components (e.g., ducting) to cool the operation of the CVT. Intake **1102** brings air into the housing and exit port **1104** releases the heated air from the housing **1112**. The intake **1102** can face a perpendicular direction to vehicle travel, face a parallel direction to vehicle travel, or face angles in between perpendicular and parallel vehicle travel, so long as sufficient air is gathered and moved through the handling system to cool the CVT.

[0042] In the present example, the engine **1116** is shown with a single, two-stroke cylinder **1114**. The single cylinder, two-stroke engine provides durability, simplicity, and lighter weight to the vehicle. Four-stroke engines and multi-cylinder two-stroke engines can also be used, but at the possible sacrifice of weight and size.

[0043] Referring to FIG. 17, a perspective view **100** of a snow vehicle with a two-ski configuration is shown, according to some embodiments. In place of a motorcycle-type fork, a single tube fork connection and accompanying suspension can be utilized to provide a two-ski configuration as an optional kit in place of the single ski configuration. A side view **700** (see FIG. 18) and top down view **1000** (see FIG. 19) are also shown. The two-ski configuration would allow for a snow bike feel, with increased stability and balance.

[0044] A front suspension subframe assembly **1708** connects with the frame **104**. Steering mechanism **1702** connects with the handlebars **102** and steering shaft **1710**, positioned within each spindle **1712**. The spindle **1712** connects with each ski **112**. A trailing arm **1706** connects with the frame and each spindle **1712**. Radius arms **1704** connect with the spindles **1712** and subframe assembly **1708**. Dampening components, such as shocks, springs, coils (not shown), can be attached to the subframe assembly **1708** and spindles **1712**, for example.

[0045] Other embodiments of the present disclosure are possible. Although the description above contains much specificity, these should not be construed as limiting the scope of the disclosure, but as merely providing illustrations of some of the presently preferred embodiments of this

disclosure. It is also contemplated that various combinations or sub-combinations of the specific features and aspects of the embodiments may be made and still fall within the scope of this disclosure. It should be understood that various features and aspects of the disclosed embodiments can be combined with or substituted for one another in order to form various embodiments. Thus, it is intended that the scope of at least some of the present disclosure should not be limited by the particular disclosed embodiments described above.

[0046] Thus, the scope of this disclosure should be determined by the appended claims and their legal equivalents. Therefore, it will be appreciated that the scope of the present disclosure fully encompasses other embodiments which may become obvious to those skilled in the art, and that the scope of the present disclosure is accordingly to be limited by nothing other than the appended claims, in which reference to an element in the singular is not intended to mean "one and only one" unless explicitly so stated, but rather "one or more." All structural, chemical, and functional equivalents to the elements of the above-described preferred embodiment that are known to those of ordinary skill in the art are expressly incorporated herein by reference and are intended to be encompassed by the present claims. Moreover, it is not necessary for a device or method to address each and every problem sought to be solved by the present disclosure, for it to be encompassed by the present claims. Furthermore, no element, component, or method step in the present disclosure is intended to be dedicated to the public regardless of whether the element, component, or method step is explicitly recited in the claims.

[0047] The foregoing description of various preferred embodiments of the disclosure have been presented for purposes of illustration and description. It is not intended to be exhaustive or to limit the disclosure to the precise embodiments, and obviously many modifications and variations are possible in light of the above teaching. The example embodiments, as described above, were chosen and described in order to best explain the principles of the disclosure and its practical application to thereby enable others skilled in the art to best utilize the disclosure in various embodiments and with various modifications as are suited to the particular use contemplated. It is intended that the scope of the disclosure be defined by the claims appended hereto

[0048] Various examples have been described. These and other examples are within the scope of the following claims.

What is claimed is:

1. A snow vehicle, comprising:
an engine, mounted on a frame;
a drive track;
a drive train, operatively interconnecting the engine with the drive track for delivering propulsive power to the drive track;
an exhaust system; and
wherein the drive train includes a continuously variable transmission (CVT) positioned within a CVT housing.
2. The snow vehicle of claim 1, wherein the CVT housing includes an air handling system for cooling the CVT.
3. The snow vehicle of claim 2, wherein the air handling system comprises an air intake and air exit port.
4. The snow vehicle of claim 1, wherein the exhaust system is positioned within an interior of the frame of the vehicle.

5. The snow vehicle of claim 1, further comprising a muffler in contact with the exhaust system.

6. The snow vehicle of claim 5, wherein the muffler is positioned within an interior of the frame.

7. The snow vehicle of claim 1, further comprising an air intake system, in contact with the engine.

8. The snow vehicle of claim 7, wherein the air intake system is rear facing.

9. The snow vehicle of claim 7, wherein the air intake system is positioned on top of the engine and in contact with the frame.

10. The snow vehicle of claim 1, further comprising an engine cooling system.

11. The snow vehicle of claim 10, further comprising a heat exchanger positioned above the drive track.

12. The snow vehicle of claim 10, further comprising a shroud, positioned above the cooling system.

13. A snow vehicle, comprising:

an engine, mounted on a frame;

a drive track;

a drive train, operatively interconnecting the engine with the drive track for delivering propulsive power to the drive track; and

an engine air intake system, positioned above the engine; wherein the air intake system includes a rearward positioned air intake port.

14. The snow vehicle of claim 13, wherein the air handling system comprises an air intake and air exit port.

15. The snow vehicle of claim 13, further comprising a muffler in contact with the exhaust system.

16. The snow vehicle of claim 15, wherein the muffler is positioned within an interior of the frame.

17. The snow vehicle of claim 13, further comprising an exhaust system positioned with an interior of the frame.

18. The snow vehicle of claim 13, wherein the air intake system is rear facing.

19. The snow vehicle of claim 13, wherein the air intake system is positioned on top of the engine and in contact with the frame.

20. The snow vehicle of claim 13, further comprising an engine cooling system.

21. The snow vehicle of claim 20, further comprising a heat exchanger positioned above the drive track.

22. A snow vehicle, comprising:

an engine, mounted on a frame;

a drive track;

a drive train, operatively interconnecting the engine with the drive track for delivering propulsive power to the drive track;

an engine air intake system, positioned above the engine; and

an exhaust system, positioned within an interior of the frame of the vehicle;

wherein the air intake system includes a rearwardly facing air intake port;

and wherein the drive train includes a CVT.

* * * * *